

REV	DESCRIPTION OF REVISION	E.C.N.	BY	APPROVED	DATE
A	ADDED -030E		E.T.W.	E.T.W.	09-06-13
B	UPDATED DIM. TO MATCH EYELET PRINT WAS .073 DIA. & .056 DIA.		E.C.	E.T.W.	09-03-14

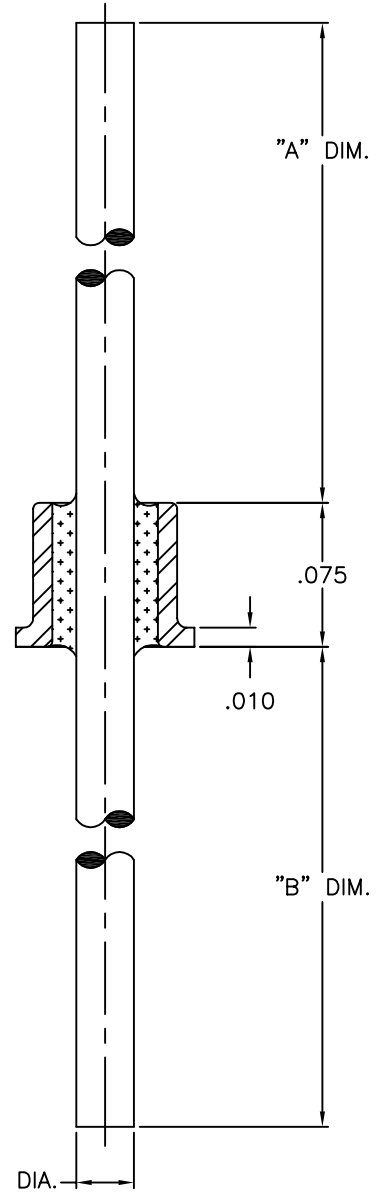
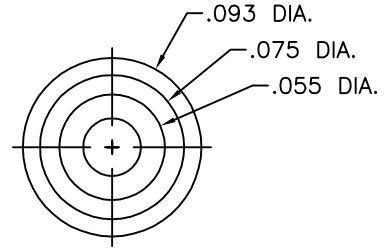

FT-092-030E T16	.200±.010	.275±.010
FT-092-030D T16	.479±.010	.507±.010
FT-092-030B T16	1.430±.025	.570±.010
FT-092-030A T16	.203±.010	.222±.010
PART NO.	"A" DIM.	"B" DIM.

**MATERIAL:**

EYELET - 1010 C.R.S.  
GLASS - 9013 OR EQUAL.  
LEADS - ASTM F-30, 52 ALLOY.

**PLATING:**

1. PLATE EYELET AND LEADS PRIOR TO FUSING WITH ELECTROLYTIC NICKEL. AFTER FUSING PLATE PER MIL-STD QQ-S-571-D TIN LEAD ALLOY.

DRAWN BY: E.T.W. 10-29-10	MATERIAL: SEE ABOVE	TOLERANCING PER ANSI Y14.5 .X ± .005 .XXX ± .005 .XX ± .005 ANG ± 5 UNLESS OTHERWISE SPECIFIED		<p>Legacy Technologies Inc.</p> <p>6700 W. 47th TERR. MISSION, KS. 66203 TEL: 913-432-2487 FAX: 913-432-0570</p>	
CHECKED BY: E.T.W. 10-29-10	APP. SPECS	SUPERSEDES	NEXT ASSY		PART NUMBER: SEE PART NO.
APPROVED BY:	TITLE: INSULATED FEED THRU	SCALE: 10:1		FINISH: UNLESS OTHERWISE SPECIFIED <input checked="" type="checkbox"/>	FILE: EA00025D
				PAGE	1 of 1